

JEI PIPE ATTACHMENTS

CHAIN BASE KITS TO ENABLE YOUR MACHINE TO DRILL TUBE AND PIPES



Specialists in Portable Magnetic Drilling Solutions
and Metal Fabricating Equipment

Part No.	Suitable for JEI Models	L [mm] (for magnet base)	W [mm] (for magnet base)	Min. Dia, of Pipe	max. Dia, of Pipe	A[mm] Min. Pipe length	B [mm] Overall Length	C [mm] Depth (for magnet base)	D [mm] Overall Width
JEICB-S	MiniBeast, Minibeast Auto , HM-40, Magbeast 2,	205	95	80 mm Dia	250mm as supplied extra chain available for Larger Dia - see part list	181	217	52,5	221
JEICB-M	HM-50, HM50T	205	95	80 mm Dia	250mm as supplied extra chain available for Larger Dia - see part list	181	217	52,5	221

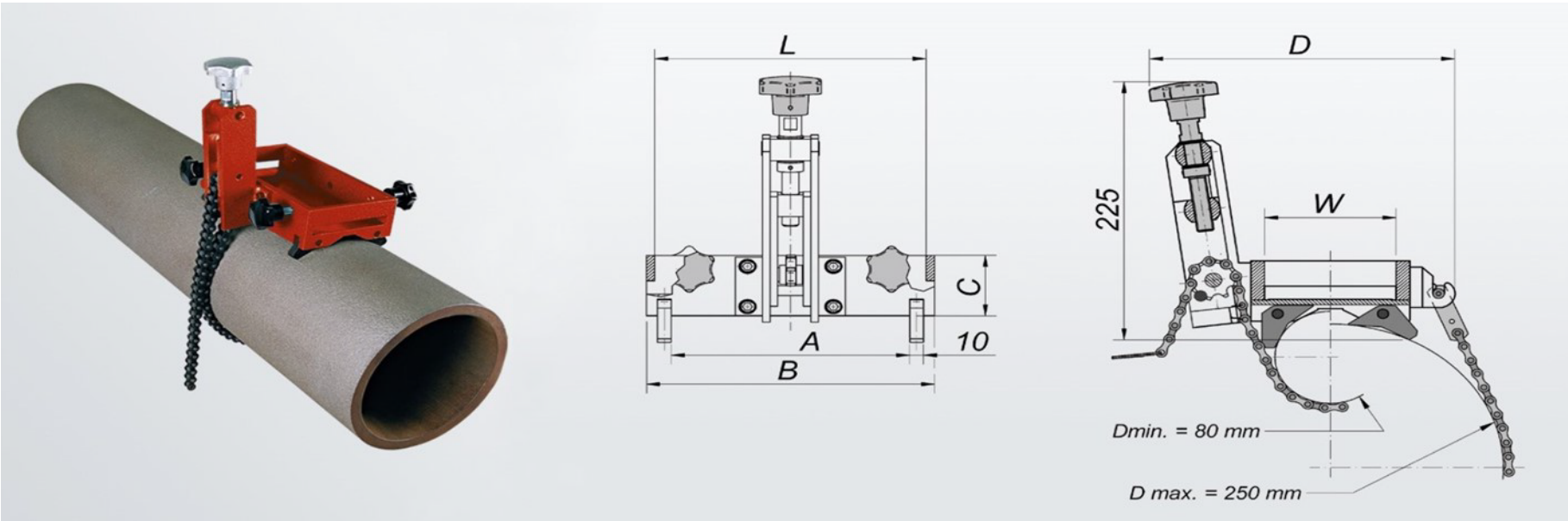

Part No.	Suitable for JEI Models	L [mm] (for magnet base)	W [mm] (for magnet base)	Min. Dia, of Pipe	max. Dia, of Pipe	A[mm] Min. Pipe length	B [mm] Overall Length	C [mm] Internal Depth (for magnet base)	D [mm] Overall Width
JEICB-L	Magbeast 4	258	130	150 mm Dia	500mm as supplied extra chain available for Larger Dia - see part list	234	270	52,5	260
JEICB-XL	HM-100, HM-100T	258	130	150 mm Dia	500mm as supplied extra chain available for Larger Dia - see part list	234	270	52,5	260

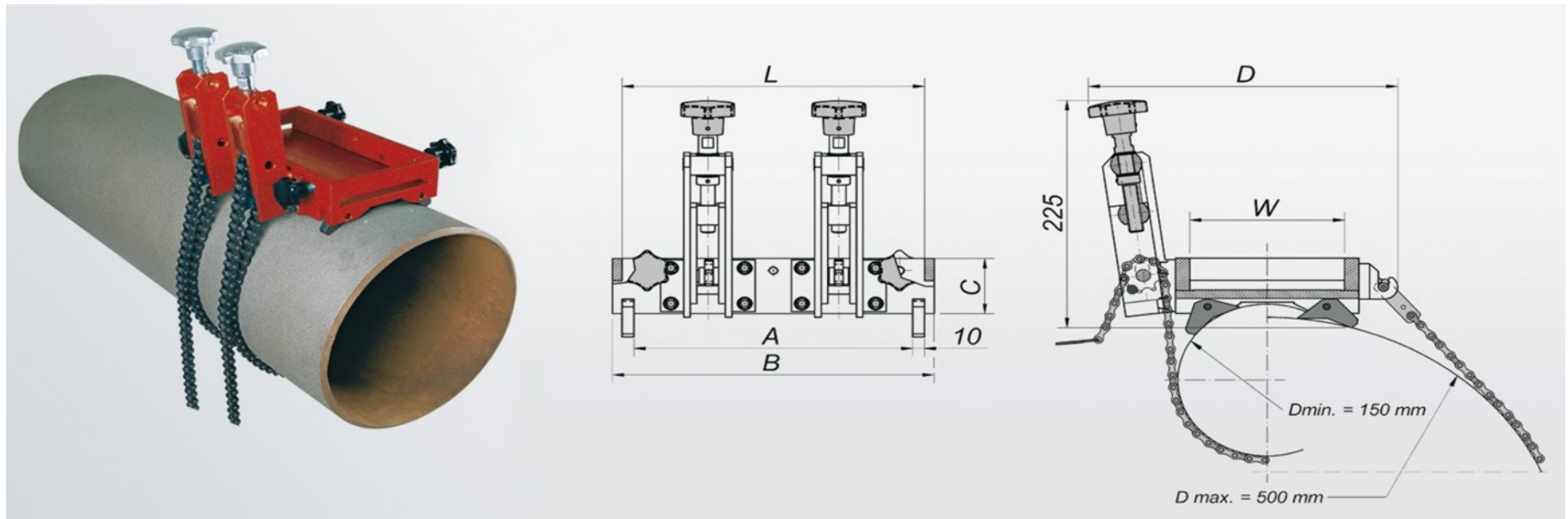

Tel: +44 (0) 1706 229490
Fax: + 44 (0) 1706 507347
Email: sales@jeisolutions.co.uk
Web: www.jeiuk.com

JEI DRILLING & CUTTING SOLUTIONS LIMITED
UNIT 21, ENTERPRISE BUSINESS PARK,
ENTERPRISE WAY, BURNLEY, LANCASHIRE BB12 6LT, U.K.